

PRESENTATION

TECHNICAL PRODUCT
INFORMATION

ALUFIRE[®]
FIRE-RESISTANT
ALUMINIUM
JOINERY
SYSTEMS

MORE INFO:

[alufire
.com](https://alufire.com)

PROFILE COMPARISON

ALUFIRE
PARTITIONS

CLASSIC LINE & AVL:
EI15-EI30

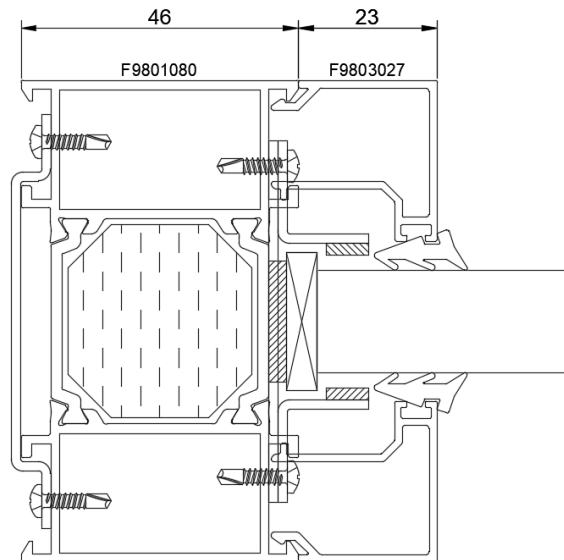

CLASSIC LINE & AVL:
EI45-EI60

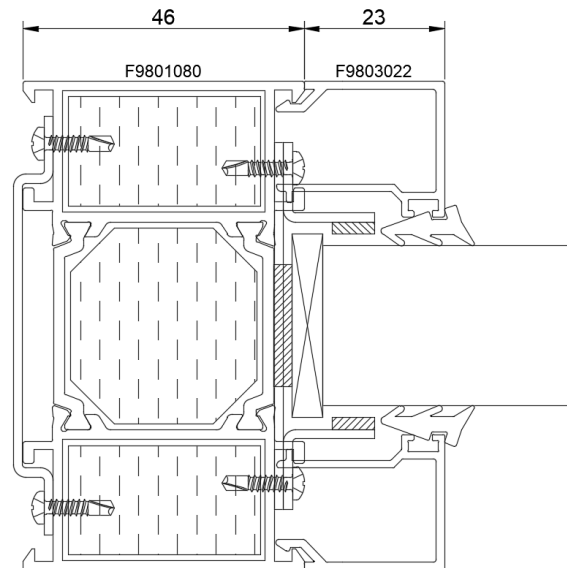

CLASSIC LINE:
EI120

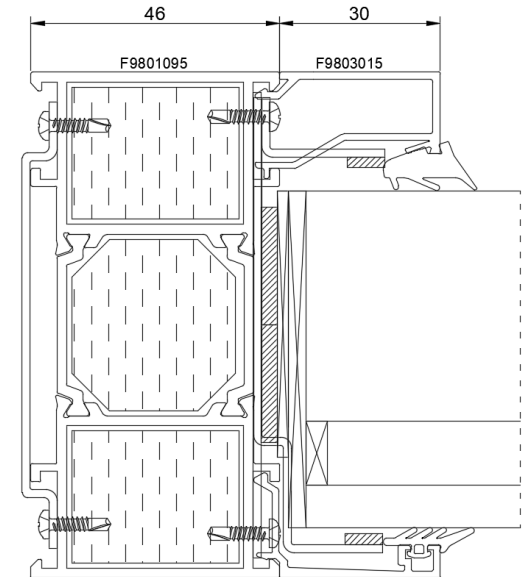

GLAZING COMPARISON

ALUFIRE
PARTITIONS

PARTITIONS: EI15-EI30

PYROBEL 16



PYROSTOP 30-10

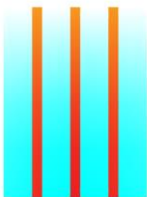

PARTITIONS: EI45-EI60

PYROBEL 25



PYROSTOP 60-101

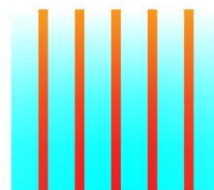

PARTITIONS: EI120

PYROBEL 54



PYROSTOP 120-10

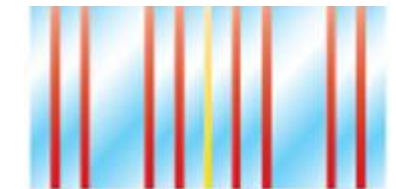

DIMENSIONS & DIVISIONS

FIRE RESISTANCE
CLASSES: **EI45 – EI60**

ALUFIRE CLASSIC LINE

Dimensions according to slide no 9

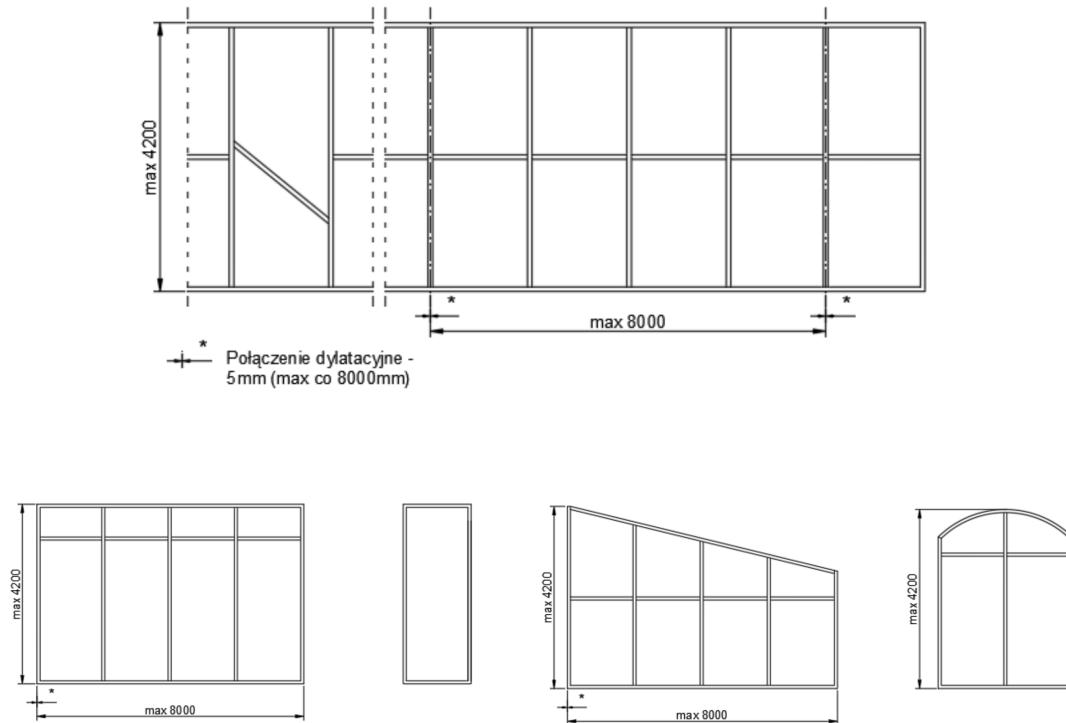

ALUFIRE VISION LINE (AVL)

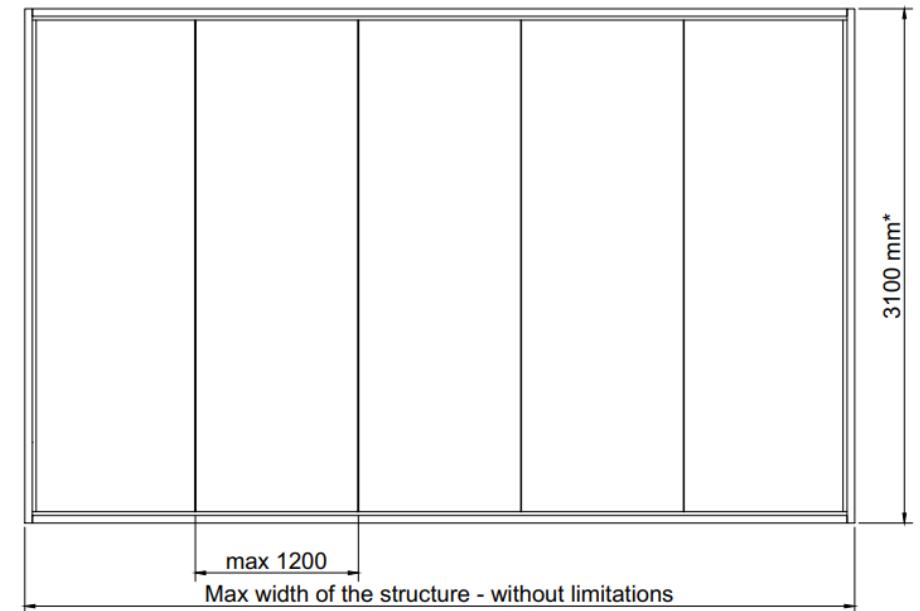

* height dimension above 3100 mm requires individual consideration

DIMENSIONS & DIVISIONS

FIRE RESISTANCE
CLASS: **EI120**

ALUFIRE CLASSIC LINE

Dimensions according to slide no 10

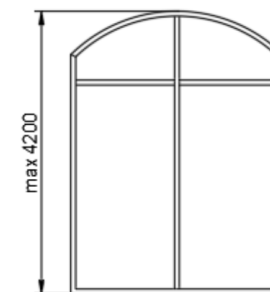
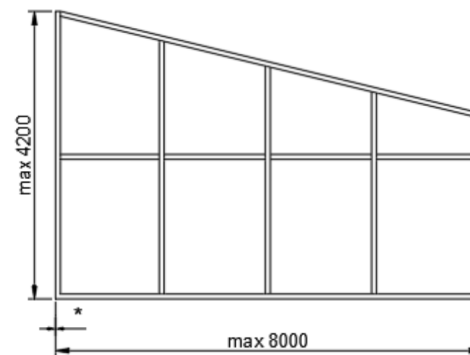
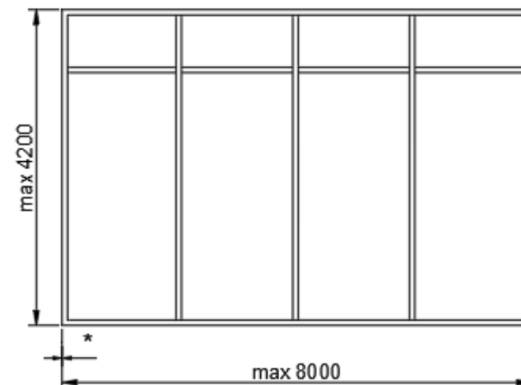
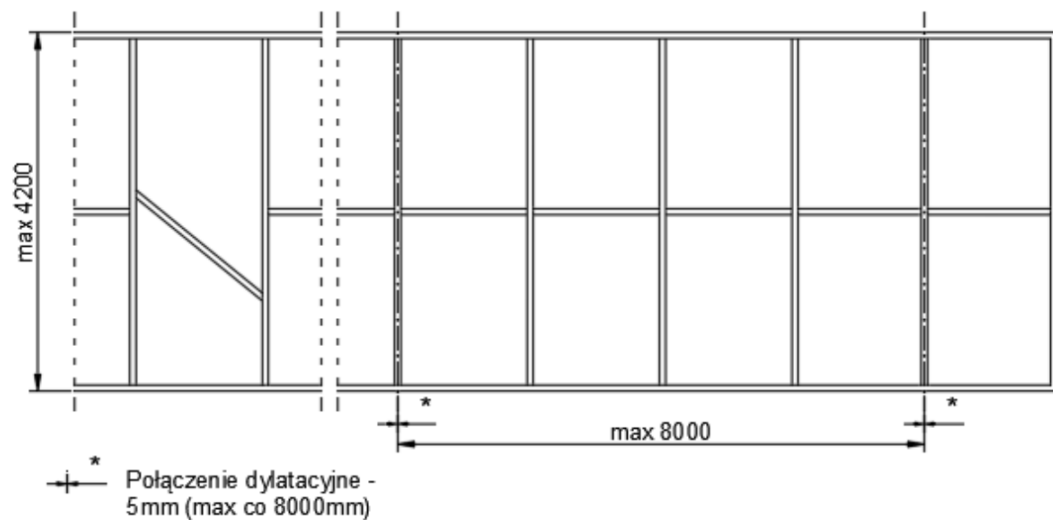

NOISE INSULATION PROPERTIES

ALUFIRE
PARTITIONS



NOISE INSULATION: (R_w)

Classic Line

Vision Line

EI30

up to 41dB

39dB; 44dB

EI60

up to 44dB

39dB; 47dB

GLASS DIMENSIONS

FIRE RESISTANCE
CLASSES: **EI15** – **EI30**

AGC GLASS

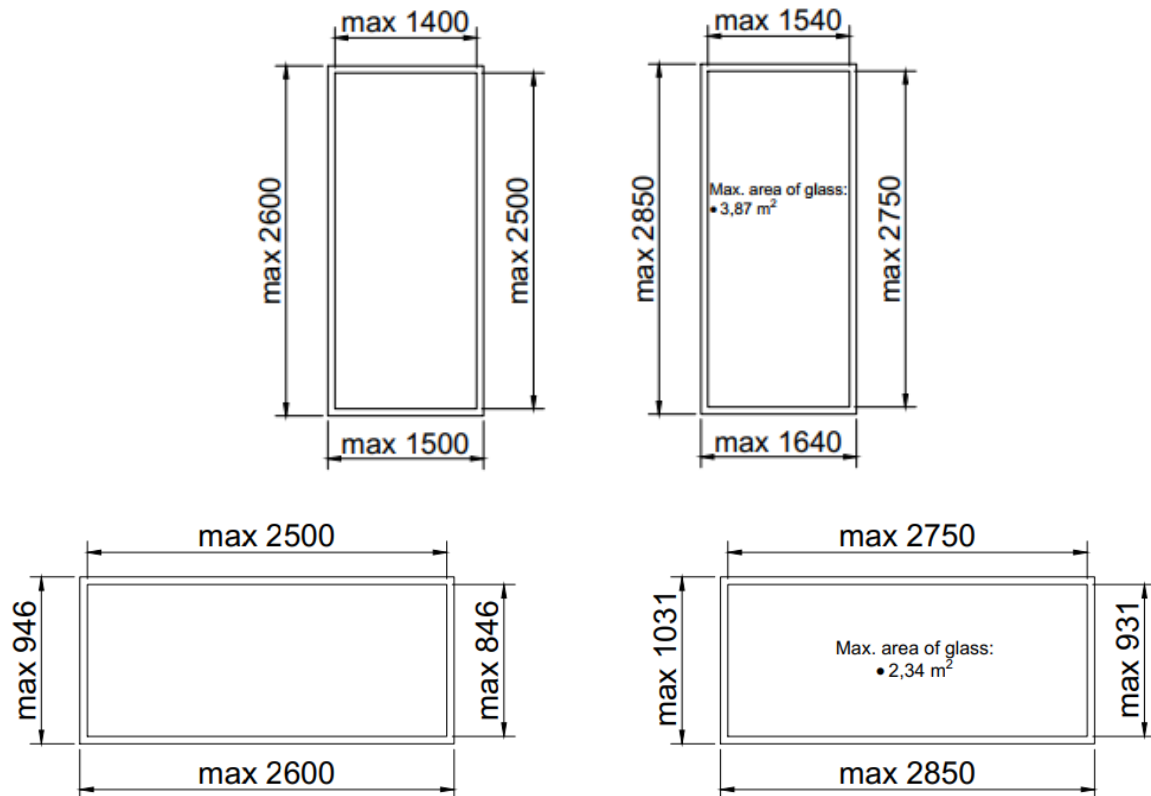

IGP GLASS

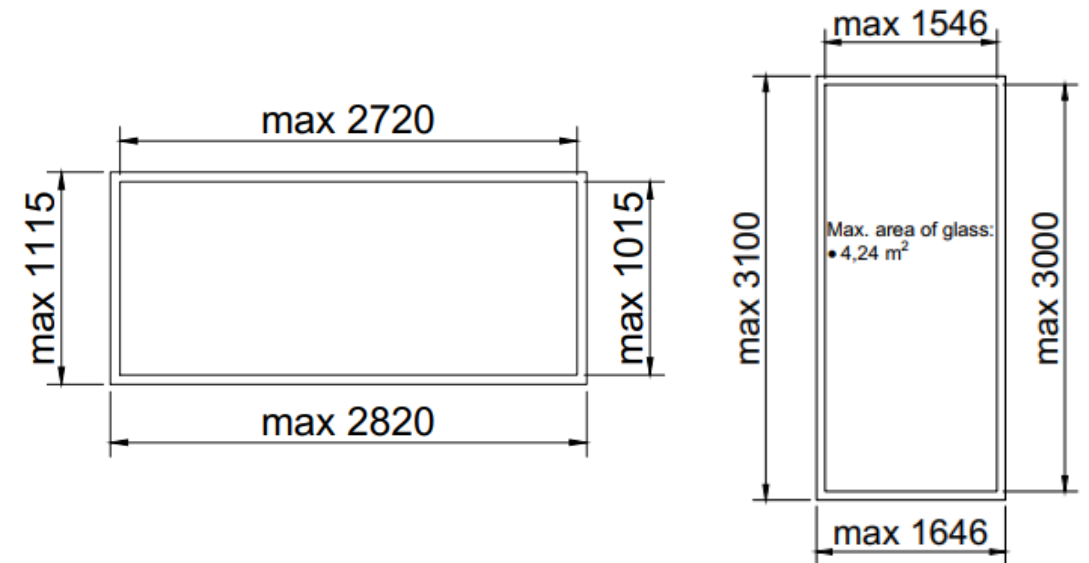

GLASS DIMENSIONS

FIRE RESISTANCE
CLASSES: **EI45** – **EI60**

AGC GLASS

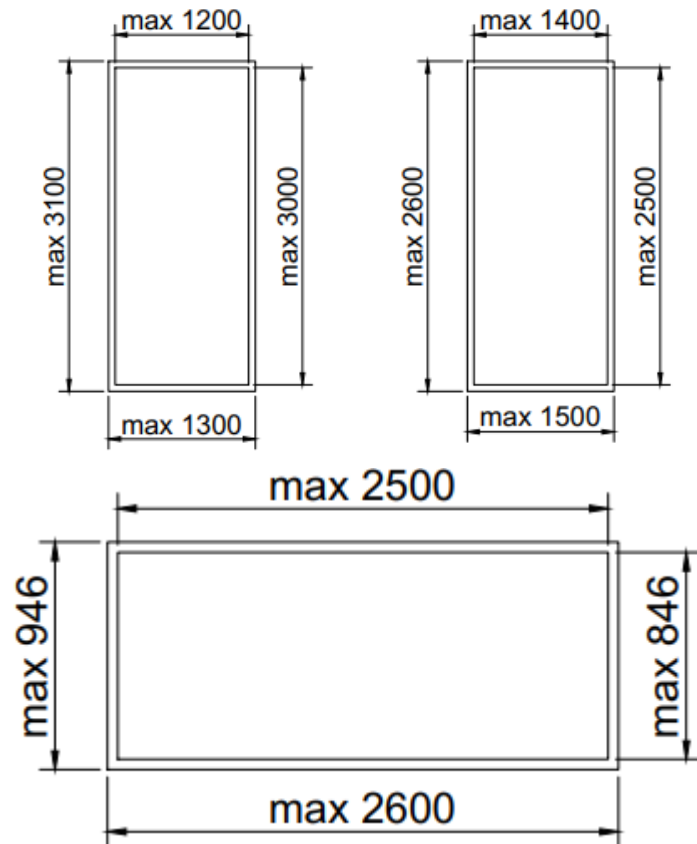

IGP GLASS

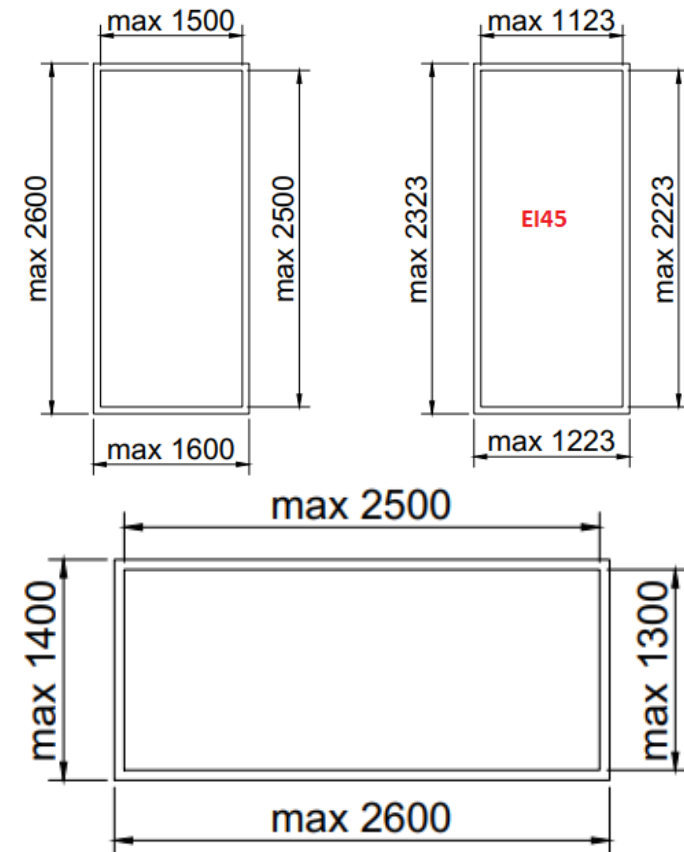

GLASS DIMENSIONS

FIRE RESISTANCE
CLASS: **EI120**

AGC GLASS

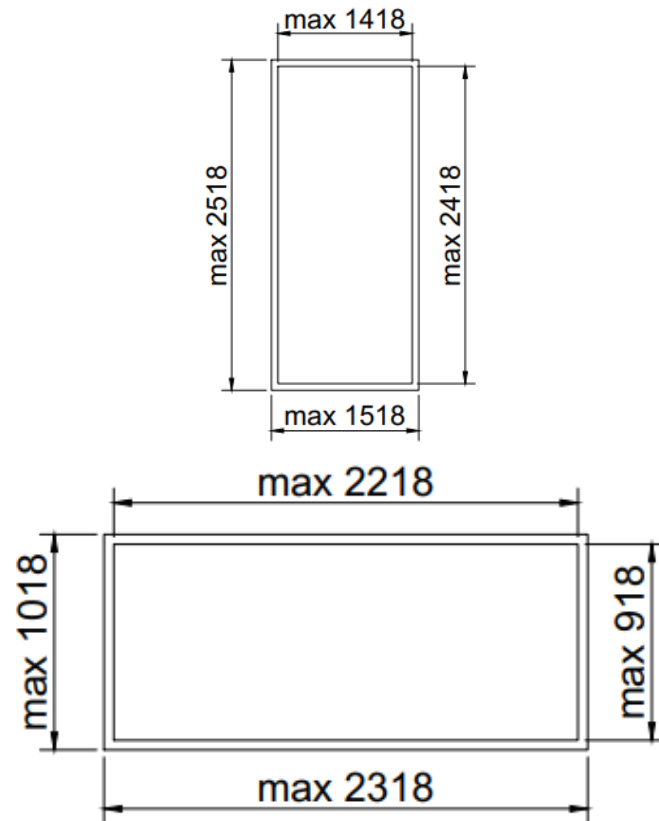

IGP GLASS

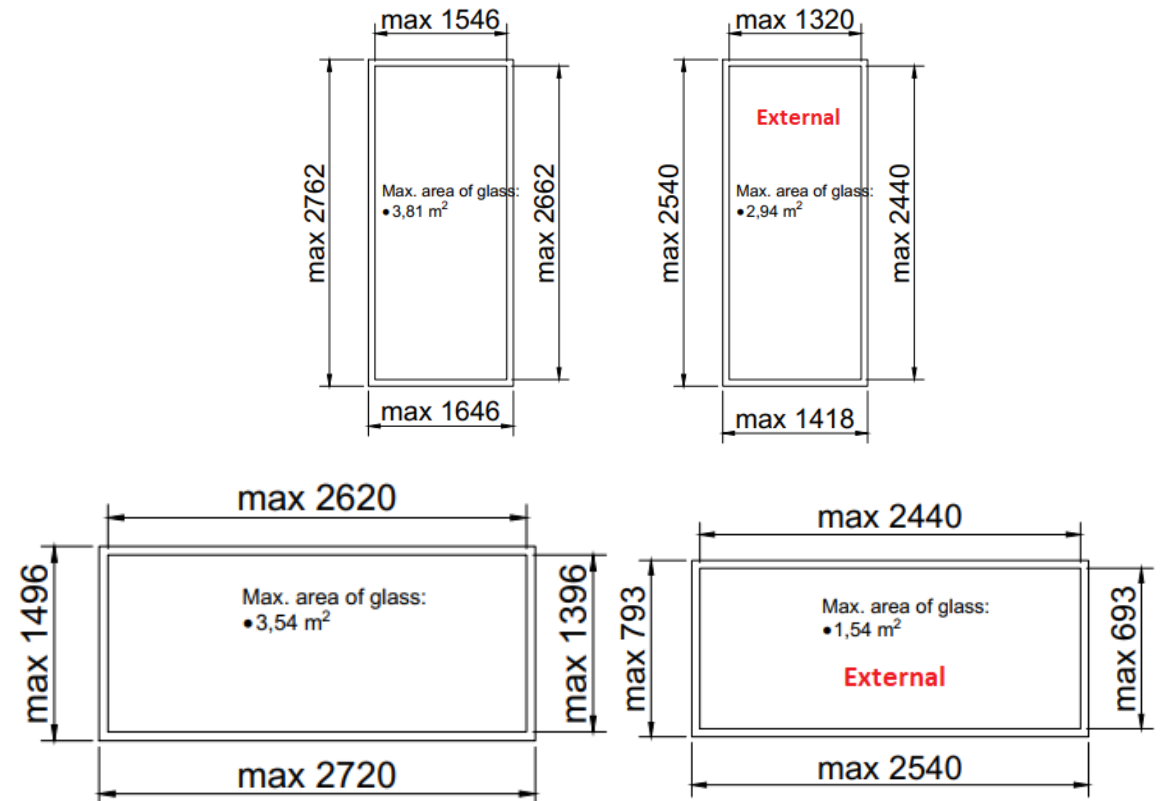

ALUMINIUM PANEL DIMENSIONS

ALUFIRE
CLASSIC LINE

PARTITIONS: EI30

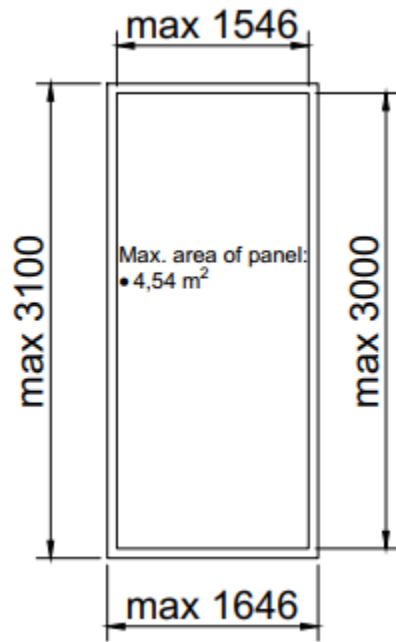

PARTITIONS: EI60

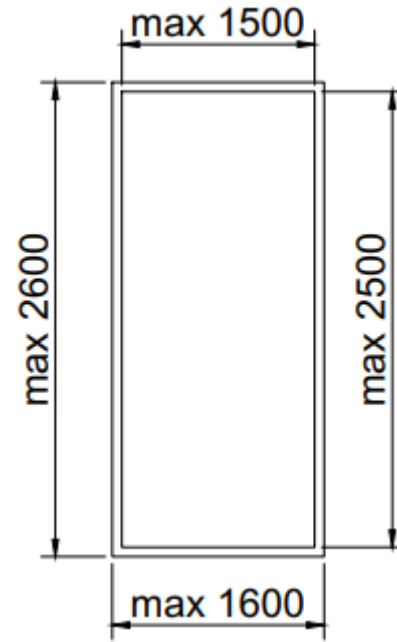

PARTITIONS: EI120

